

PLAN VIEW

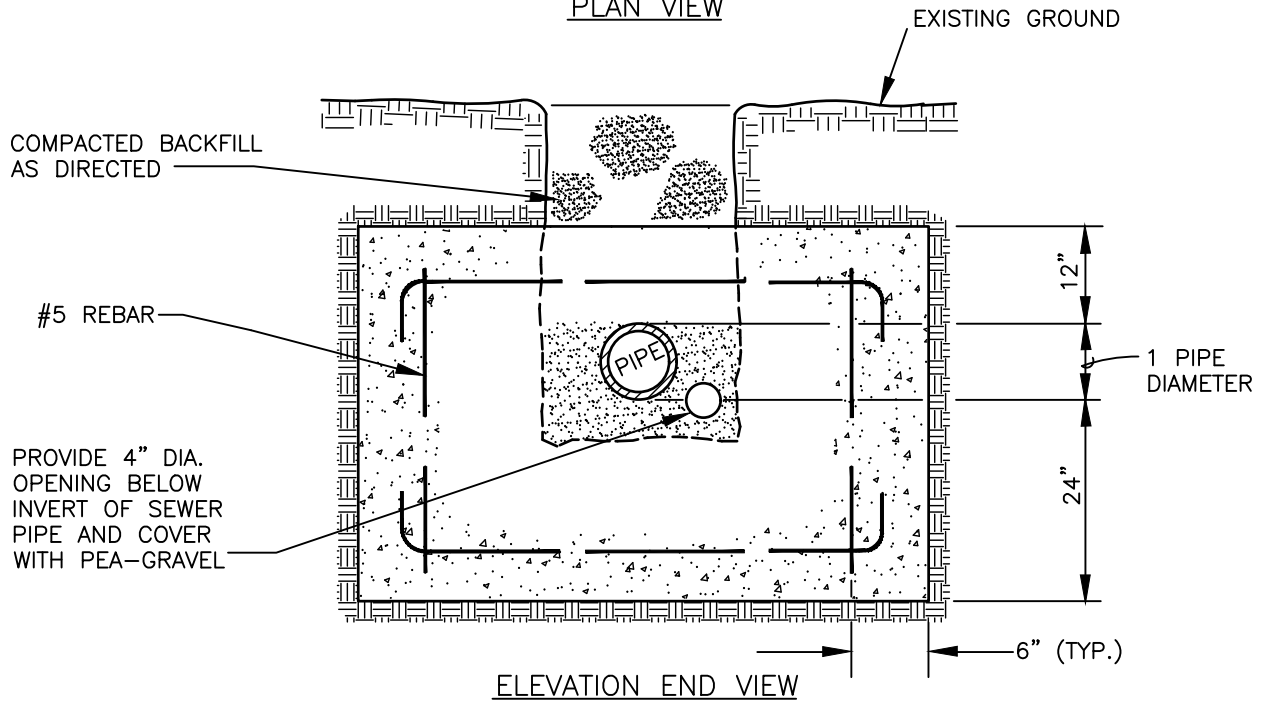

ELEVATION END VIEW

MINIMUM ANCHORAGE SPACING

PIPE ANCHORS ARE TO BE INSTALLED ON ALL SLOPES GREATER THAN 20% AS FOLLOWS:

1. NOT OVER 36 FEET CENTER TO CENTER ON GRADES 20% & UP TO 35%.
2. NOT OVER 24 FEET CENTER TO CENTER ON GRADES 35% & UP TO 50%.
3. NOT OVER 16 FEET CENTER TO CENTER ON GRADES 50% & OVER.

THIS ANCHOR BLOCK DETAIL REPRESENTS MINIMUM REQUIREMENTS FOR MATERIALS AND INSTALLATION.

GENERAL NOTES:

1. PROVIDE EROSION CONTROL AS REQUIRED BY JURISDICTIONAL AUTHORITY.
2. DO NOT USE ANCHORS IN SANDY MATERIAL UNLESS DIRECTED OTHERWISE BY THE DISTRICT.
3. TIGHT WRAP PIPE WITH 8 MIL. PLASTIC ON DI.
4. ANCHOR PLACED ON THE LOWER SIDE OF THE BELL.
5. FOR HDPE, BUTT FUSE RING TO OUTSIDE OF PIPE DIRECTLY ABOVE ANCHOR LOCATION. FOR C-900, INSTALL A UNIFLANGE DIRECTLY ABOVE OR IN ANCHOR.

FILE NAME: L:\CAD\DETAILS\DISTRICTS\CROSS VALLEY WATER DISTRICT\SD-11.DWG

**CROSS VALLEY WATER DISTRICT
STANDARD SEWER DETAILS**

PIPE ANCHOR

SD-11

NOT TO SCALE

FEB 2022